

Recommended PCB Board Layout

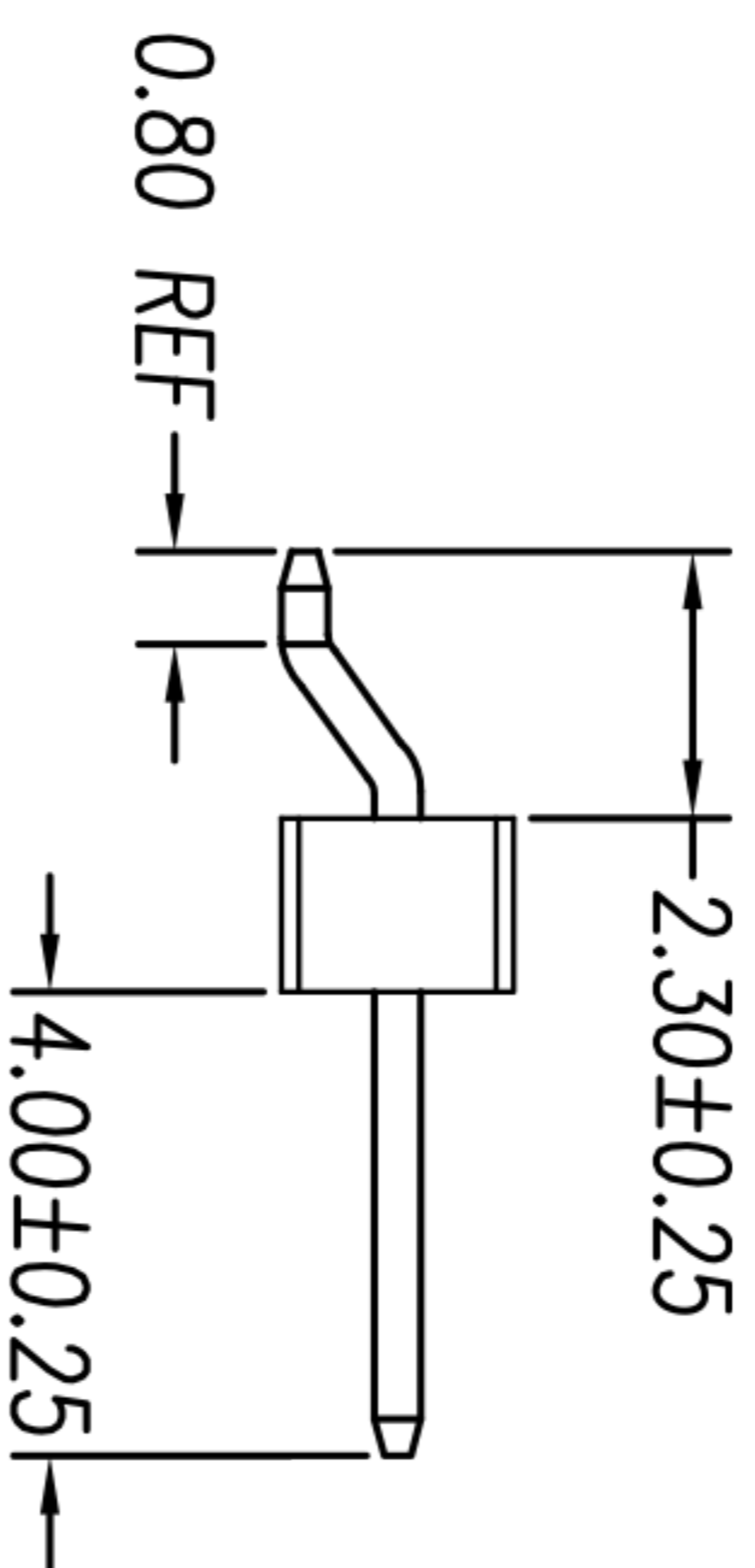

## Specifications

**Material:**  
 Contact Material: Brass  
 Contact plating: Au or Sn Over Ni  
 Insulator Material: Black Polyester UL94V-0  
 Standard: PA6T+30%G.F

**Electrical:**  
 Current rating: 1 Amps/contact max.  
 Contact resistance: 20mΩ/contact max  
 Insulation resistance: 1000MΩ min at V=100V  
 Withstanding Voltage: 300V AC/minute

**Mechanical:**  
 Mechanical life cycle: min. 200  
 Operating temperatures: Gold Plated: -55°C to +105°C  
 Tin plated: -40°C to +105°C  
 Soldering temperature: +260°C, 10s max.

ECN NO.	REV.	DATE.	DESCRIPTION.	CHANGE.	CHECK.	APPRO.
	A		NEW			

APPROVALS		DATE	<b>深圳市联丰电子有限公司</b> SHENZHEN LIANFENG ELECTRONIC CO.,LTD			
DRAWN	ZHIWEI.CHEN	2015.07.07	TITLE:	1.27 PIN HEADER	PART NO.	GP26-1270WR-S-NP
CHECKED					SCALE:	1:1
APPROVALS					PROJ:	
TOLERANCES ARE		30 <sup>±0.15</sup>	±0.30	ANGLE	UNIT:	mm
		10 <sup>±0.10</sup>	±0.20		SCALE:	1:1
		5 <sup>±0.05</sup>	±0.15	±2°	DRAWING NO.	
		~ 5	±0.10		SHEET	1 OF 1