

Poles	DIM.A	DIM.B
2A	4.25	1.25
3A	5.50	2.50
4A	6.75	3.75
5A	8.00	5.00
6A	9.25	6.25
7A	10.50	7.50
8A	11.75	8.75
9A	13.00	10.00
10A	14.25	11.25
11A	15.50	12.50
12A	16.75	13.75
13A	18.00	15.00
14A	19.25	16.25
15A	20.50	17.50
16A	21.75	18.75

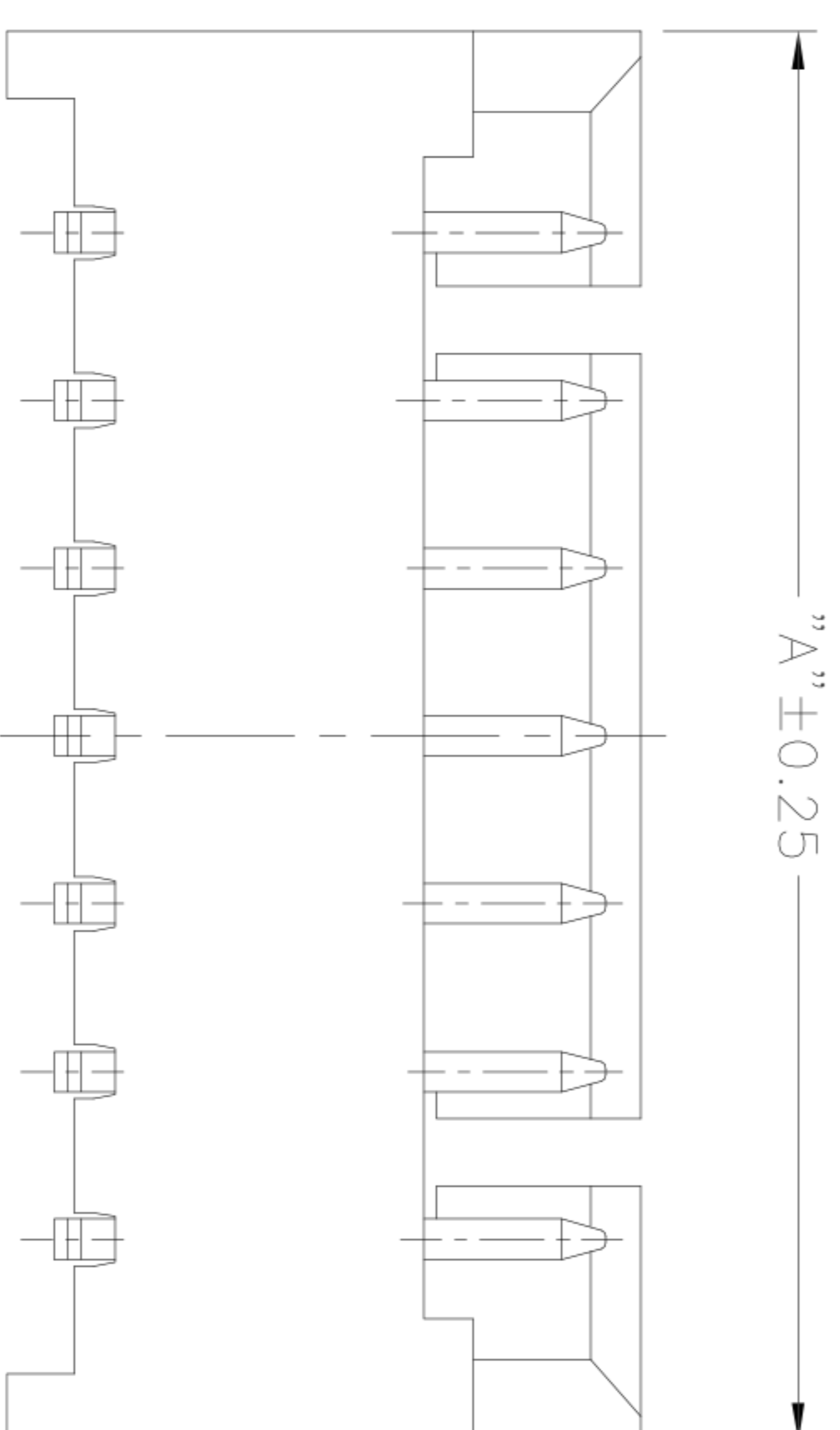

### ■ 技术参数 SPECIFICATIONS

- ◆ 适用线规
  - ◆ 额定电压: 125V DC/AC(rms)
  - ◆ 额定电流: 1A (AWG #28)  
Rated Current: 1A (AWG #28)
  - ◆ 耐压值: 250V AC/minute  
Withstand voltage: 250V AC/min.
  - ◆ 工作温度: -40°C ~ +85°C  
Working Temp : -40°C ~ +85°C
  - ◆ 绝缘电阻: ≥100 MΩ  
Insulation resistance: ≥100 MΩ
  - ◆ 接触电阻: ≤20 mΩ  
Contact resistance: ≤20 mΩ
- 材料 MATERIAL
- ◆ 绝缘体: 尼龙46, UL94-V0  
Insulator: Nylon46, UL94-V0
  - ◆ 接触针: 磷铜  
Contact PIN: Phosphor bronze

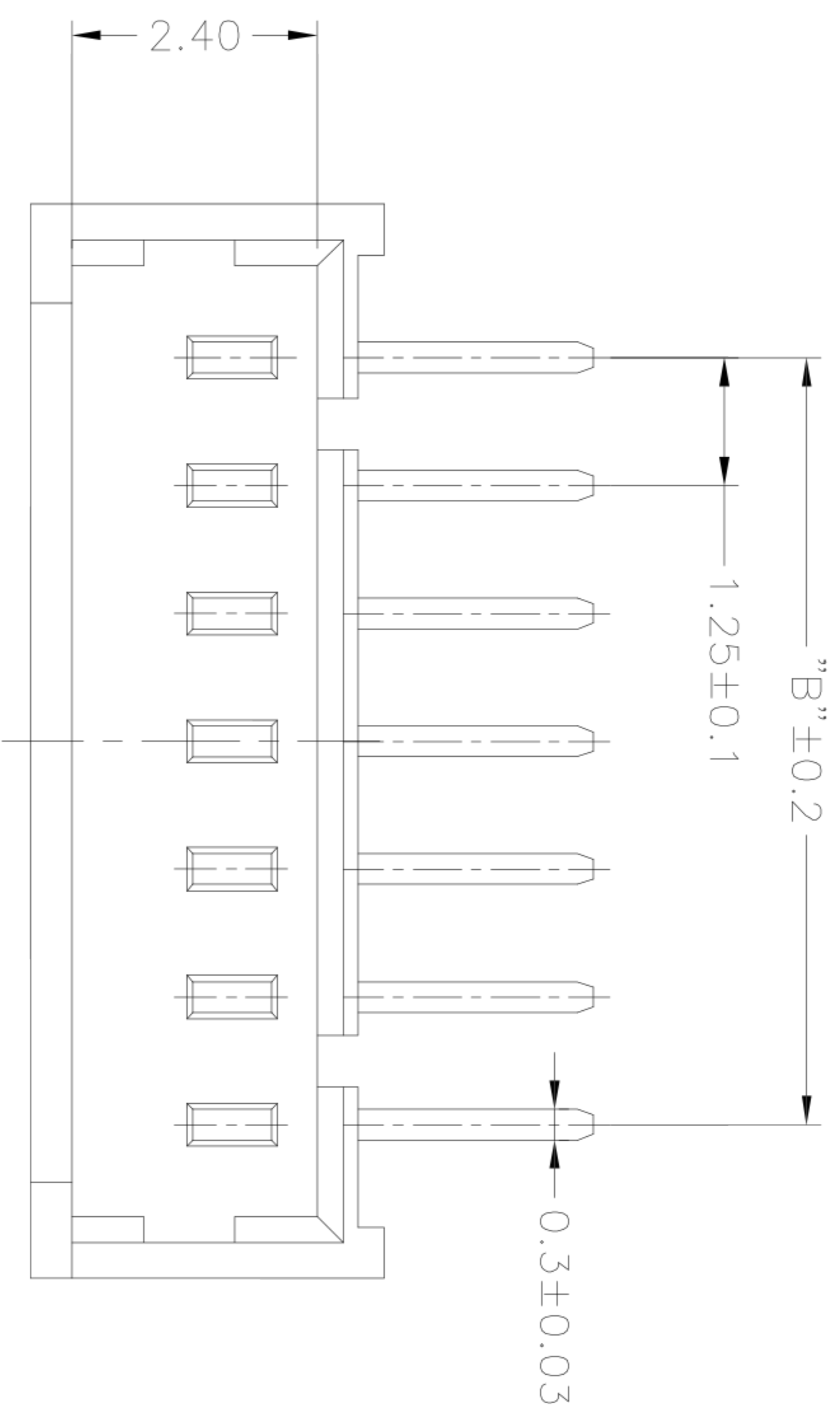
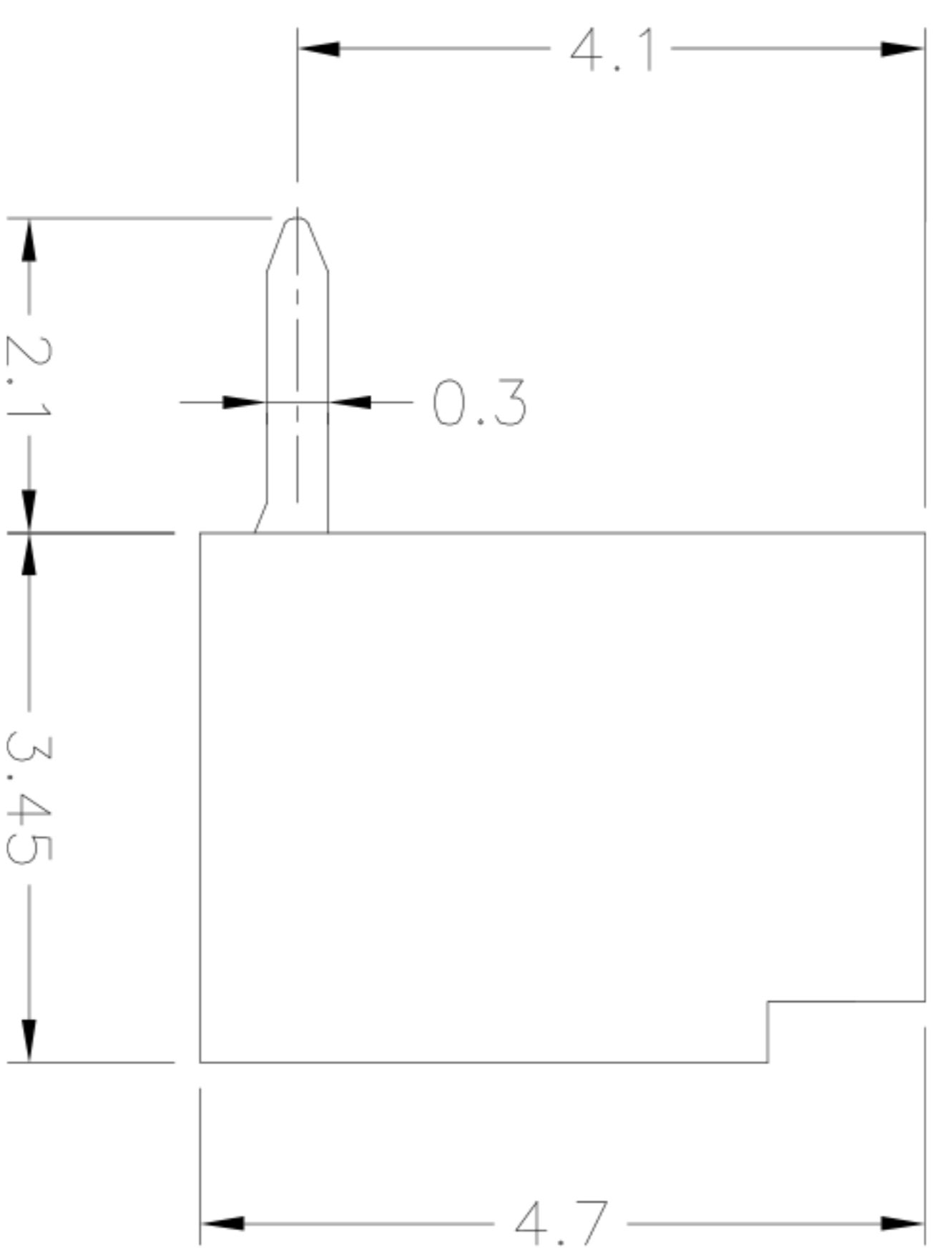
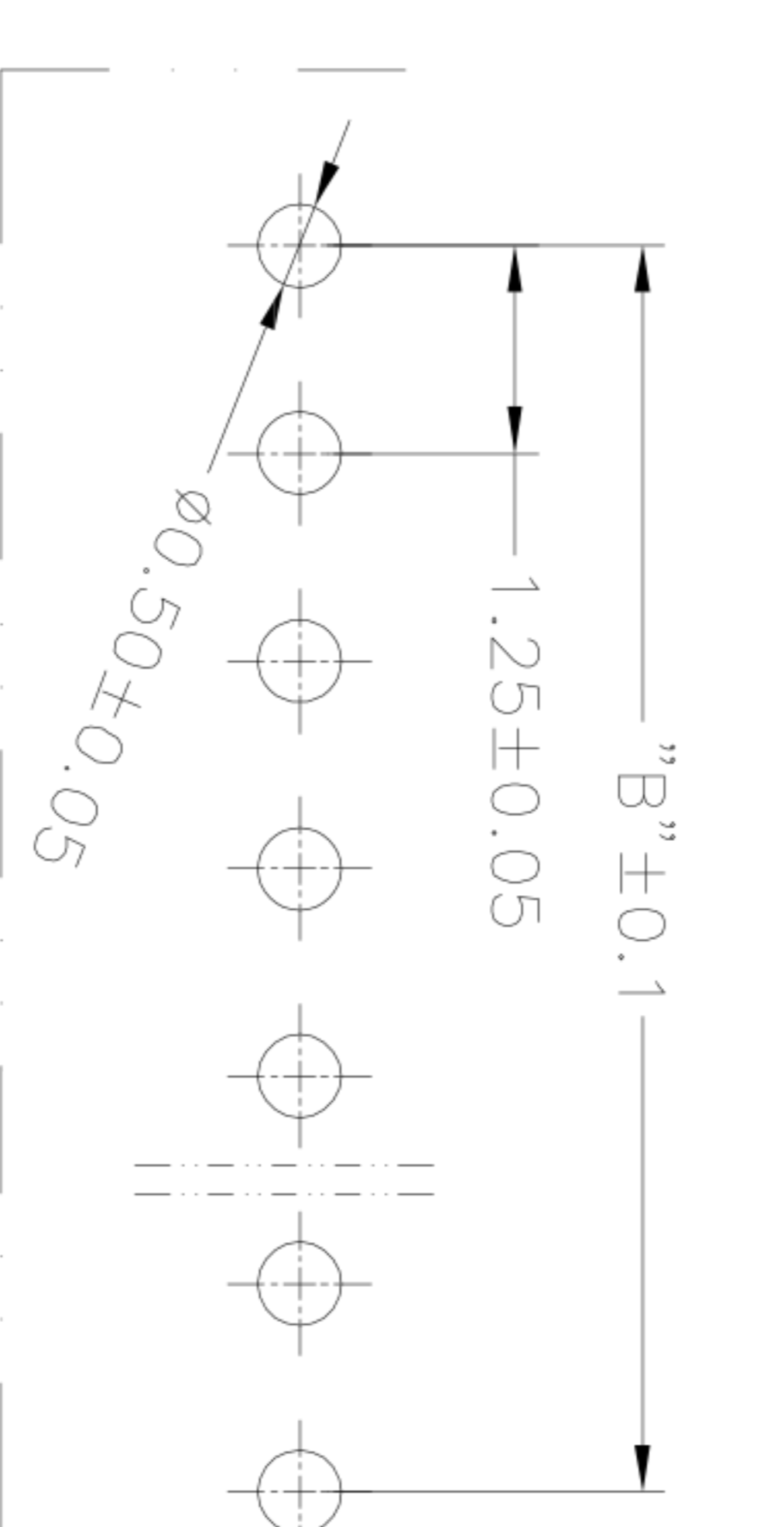

P.C.B LAYOUT

ECN NO.	REV.	DATE.	DESCRIPTION.	CHANGE.	CHECK.	APPRO.
	A		NEW			

APPROVALS		DATE	 <b>深圳市联丰电子有限公司</b> SHENZHEN LINFENG ELECTRONIC CO.,LTD
DRAWN	ZHIWEI.CHEN	2015.07.07	
CHECKED			TITLE:
APPROVALS			PART NO.
TOLERANCES ARE			UNIT: mm
30~以上	±0.30	ANGLE	SCALE: 1:1
10~30	±0.20		PROJ.
5~10	±0.15		DRAWING NO.
~ 5	±0.10	±2'	SHEET 1 OF 1