

Recommended P.C.B Layout(Top Side)
P.C.B Thickness = 1.20mm (Tolerance=±0.05)

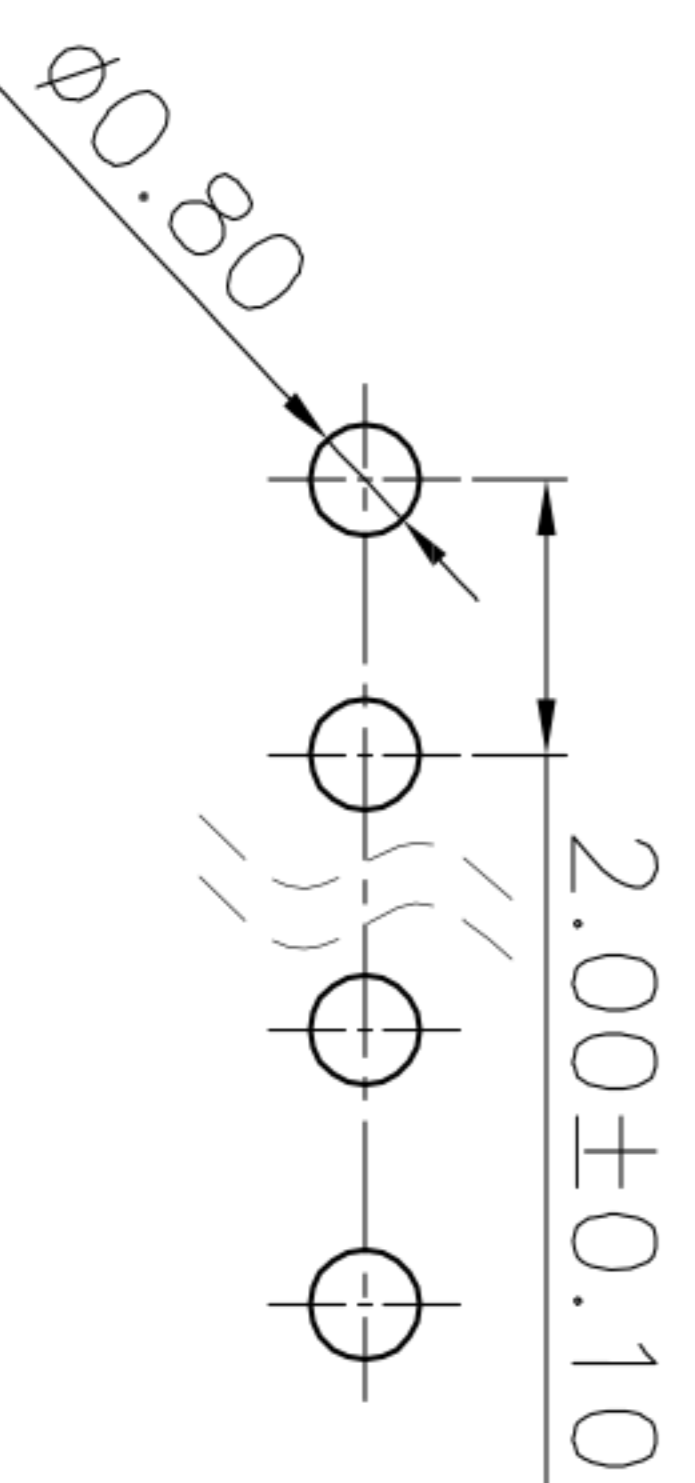

Specifications:
Current rating:4A AC/DC.
Voltage rating:125V AC/DC
Temperature range:−40°C~+105°C.
Contact resistance:10MΩ Max.
Insulation resistance:1000MΩ Min.
Withstanding voltage: 1000V AC/minute.
Material:PA66,UL94V-0.

PART NO.	Dimensions	
	A	B
2003WR-02P	2.00	5.96
2003WR-03P	4.00	7.95
2003WR-04P	6.00	9.96
2003WR-05P	8.00	11.96
2003WR-06P	10.00	13.96
2003WR-07P	12.00	15.96
2003WR-08P	14.00	17.96
2003WR-09P	16.00	19.96
2003WR-10P	18.00	21.96
2003WR-11P	20.00	23.96
2003WR-12P	22.00	25.96
2003WR-13P	24.00	27.96
2003WR-14P	26.00	29.96
2003WR-15P	28.00	31.96

ECN NO.	REV.	DATE.	DESCRIPTION.	CHANGE.	CHECK.	APPRO.
	A		NEW			

APPROVALS		DATE	TITLE:
DRAWN	ZHIWEI.CHEN	2015.07.07	
CHECKED			
APPROVALS			
TOLERANCES ARE			UNIT: mm
30~以上	±0.30	ANGLE	SCALE: 1:1
10~30	±0.20	±2'	PROJ:
5~10	±0.15		DRAWING NO.
~ 5	±0.10		SHEET 1 OF 1



深圳市联丰电子有限公司
SHENZHEN LINFENG ELECTRONIC CO.,LTD