

partno	A	B
2P	2.0	6.0
3P	4.0	8.0
4P	6.0	10.0
5P	8.0	12.0
6P	10.0	14.0
7P	12.0	16.0
8P	14.0	18.0
9P	16.0	20.0
10P	18.0	22.0
11P	20.0	24.0
12P	22.0	26.0
13P	24.0	28.0
14P	26.0	30.0
15P	28.0	32.0
16P	30.0	34.0

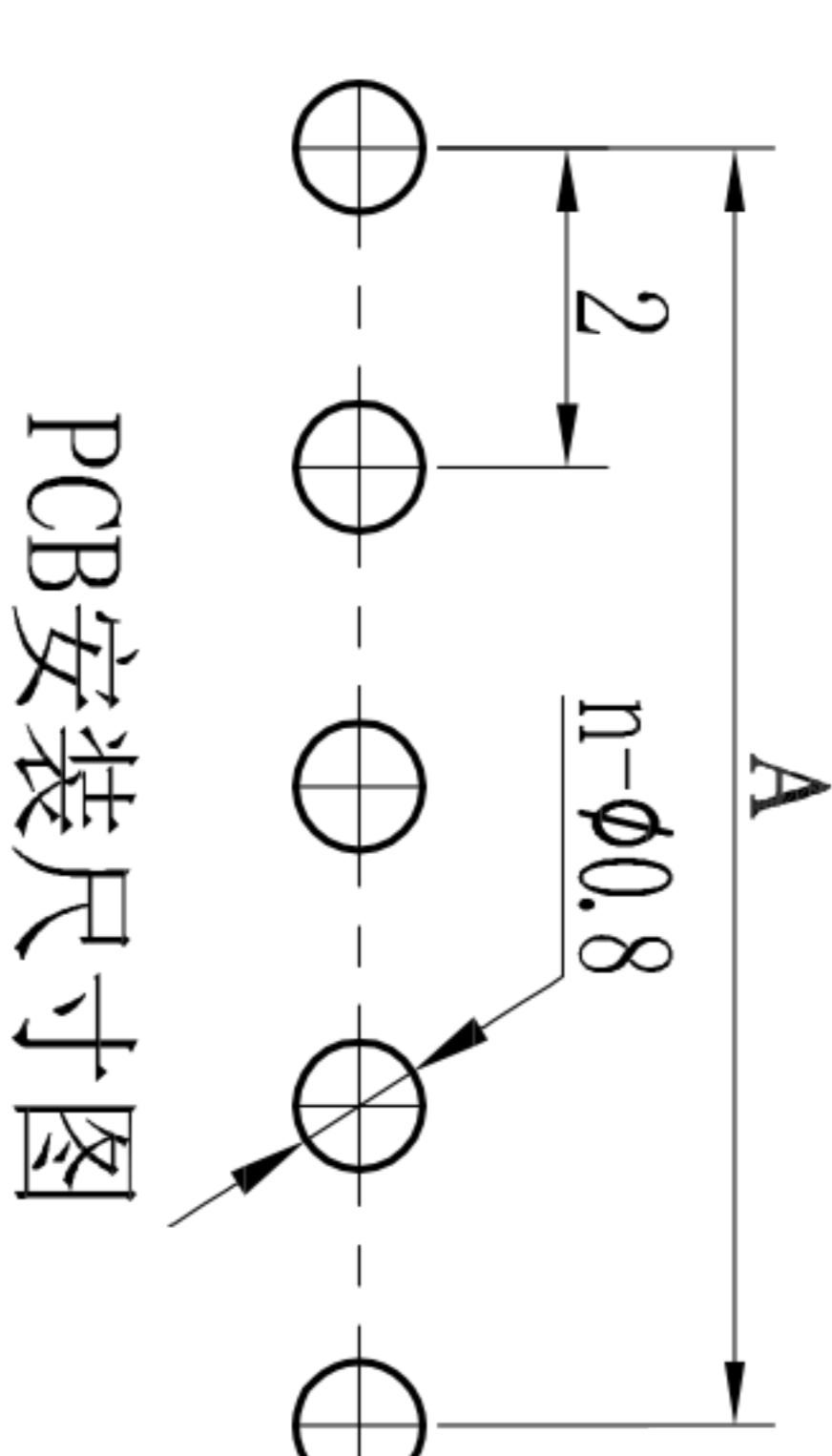
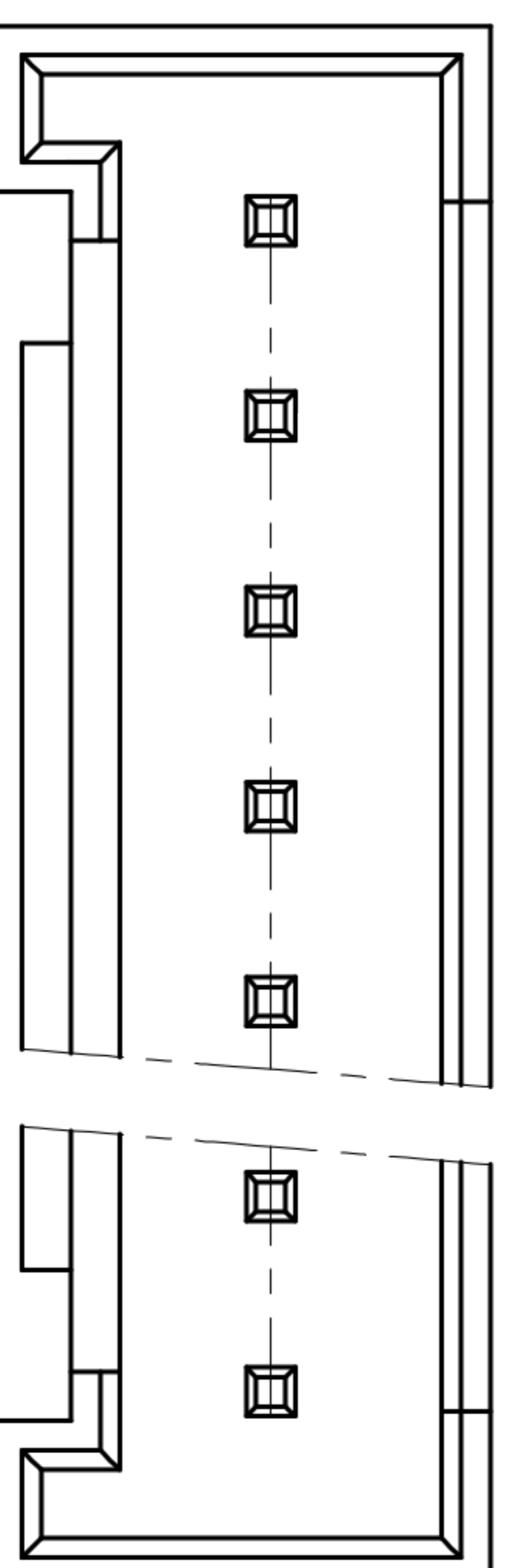
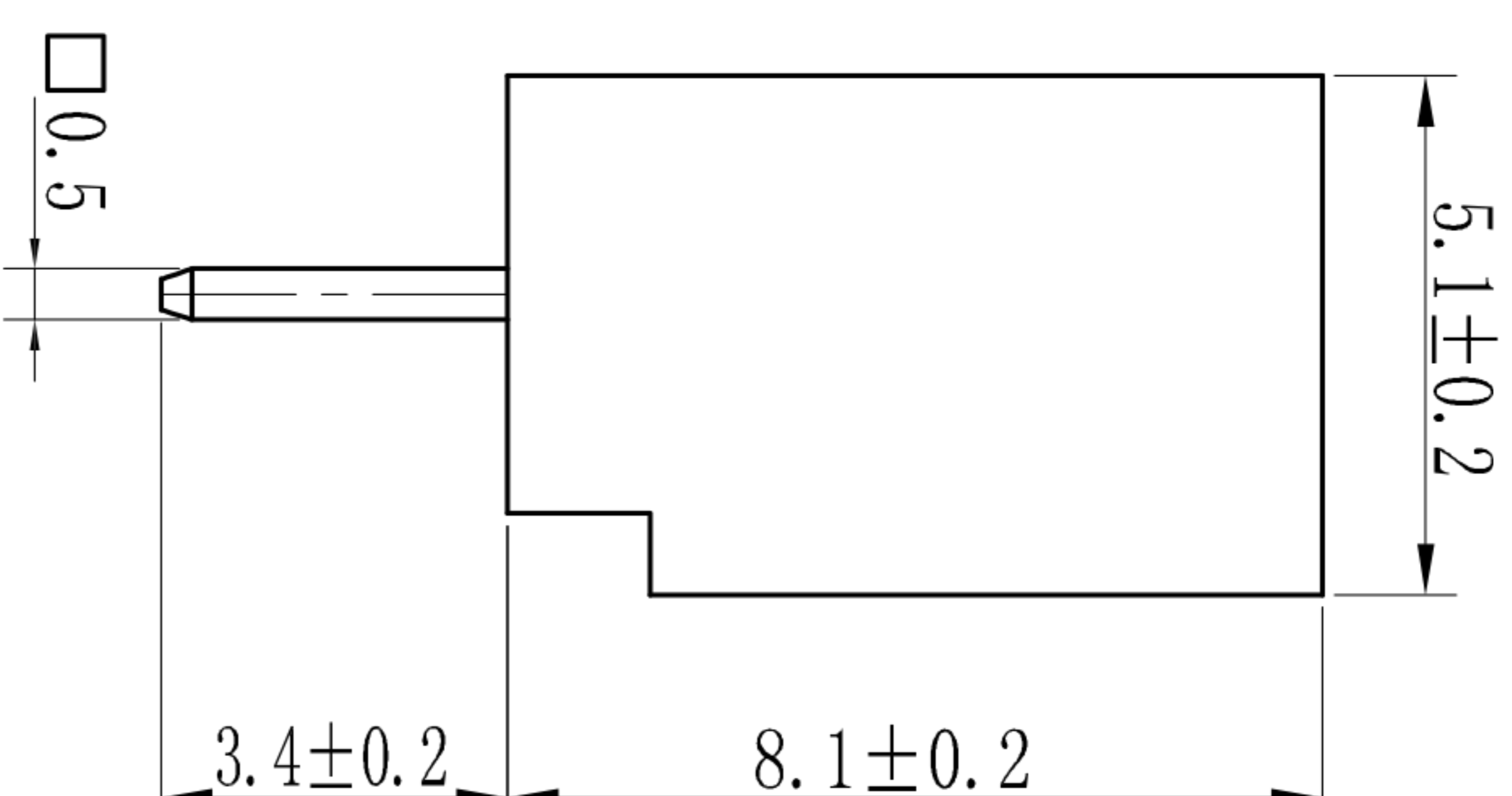
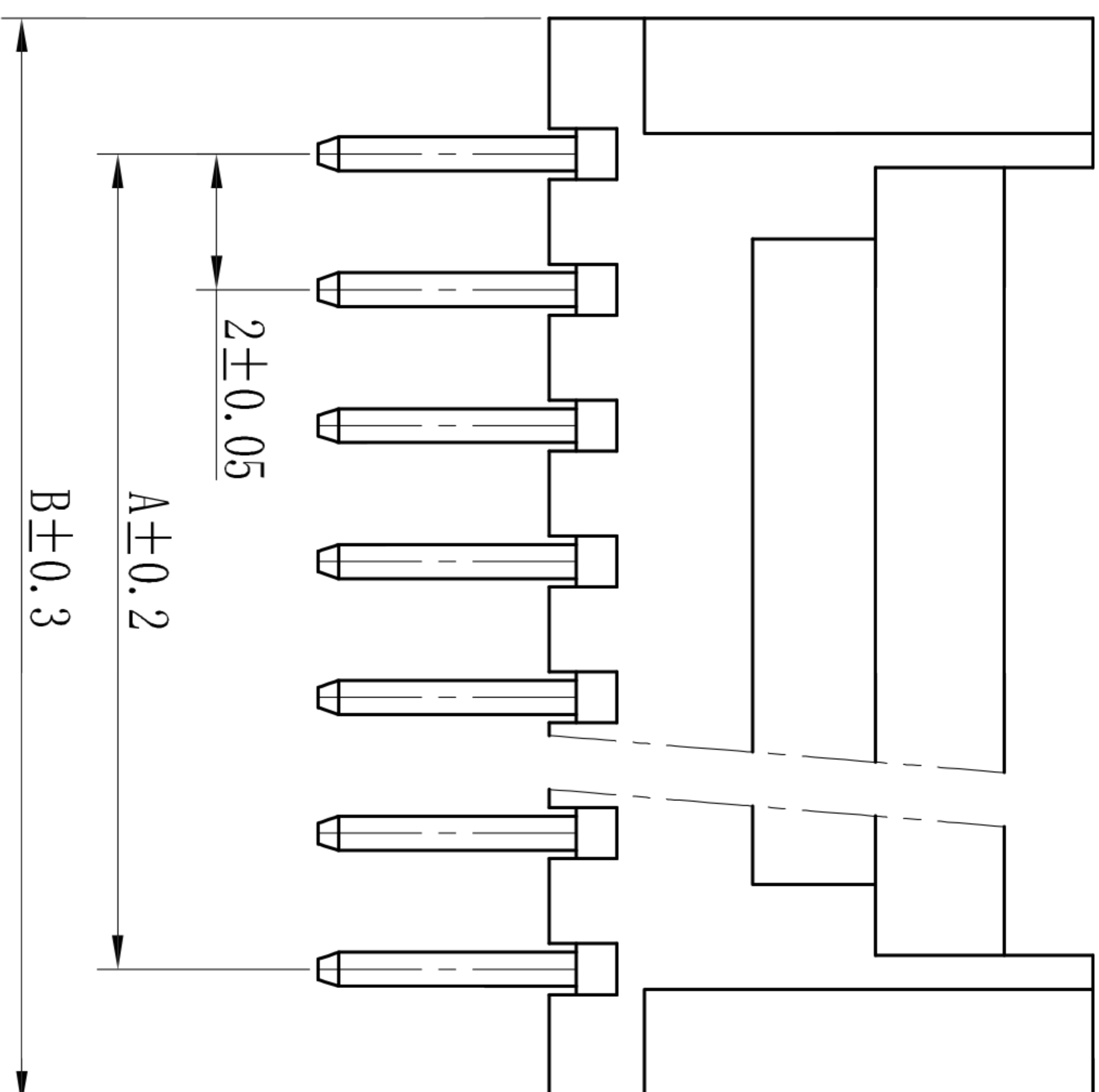

PCB安装尺寸图

■ 技术参数 (SPECIFICATIONS)

- ◆ 额定电压: 100V AC DC
- ◆ Voltage rating: 100V AC DC
- ◆ 额定电流: 1.0A AC DC MIN
- ◆ Current rating: 1.0A AC DC MIN
- ◆ 耐压值: 800V AC/minute
- ◆ Withstand voltage: 800V AC/minute
- ◆ 绝缘电阻: 800MΩ MIN
- ◆ Insulation resistance: 800MΩ MIN
- ◆ 接触电阻: 0.02Ω MAX
- ◆ Contact resistance: 0.02Ω MAX
- ◆ 工作温度: -25℃~+85℃
- ◆ Working Temperature: -25℃~+85℃
- ◆ 间距: 2.0mm
- ◆ Pitch: 2.0mm
- 材料 (MATERIAL)
- ◆ 外壳: 尼龙66
- ◆ Housing: PA66
- ◆ 插针: 黄铜
- ◆ Pin: Brass

ECN NO.	REV.	DATE.	DESCRIPTION.
—	A	—	NEW
—	—	—	CHANGE.

APPROVALS		DATE	 深圳市联丰电子有限公司 SHENZHEN LINFENYING ELECTRONIC CO.,LTD
DRAWN	ZHIWEI.CHEN	2015.07.07	
CHECKED			TITLE:
APPROVALS			PART NO.
TOLERANCES ARE			UNIT: mm
30~以上	±0.30	ANGLE	SCALE: 1:1
10~30	±0.20		PROJ:
5~10	±0.15		DRAWING NO.
~ 5	±0.10	±2'	SHEET 1 OF 1